

1. REMOVE AND INSTALL BRAKE COMPONENTS

**NOTICE:** Be careful not to damage wear shims (15). If damaged, it will be necessary to replace the entire mounting plate assembly (1).

REMOVE

- 1. Spread shoes (2) and remove adjuster assembly (13).
- 2. Remove the adjuster return spring (8).
- 3. Disengage the hold down springs (3) and pins (4) by pushing down on the spring (3) and then sliding the pin (4) until it can be removed through the hole at the end of the slot. Remove pins (4) and springs (3) from shoes (2).
- 4. Remove the shoe return spring (7) with a suitable pair of pliers.

- 5. Remove the primary and secondary shoe and lining assemblies (2).
- 6. Disassemble adjuster assembly (13) as shown in A and inspect threads for wear, burrs or damage. Replace as necessary.
- 7. Clean and inspect wear bracket (14) and wear shims (15) for burrs or damage. If the shims or bracket are unserviceable then it will be necessary to replace the mounting plate assembly (1).
- 8. Inspect the rubber boot (5) around the lever strut assembly (6). Install a new rubber boot (5) if the old boot is cracked or torn.
- 9. Inspect springs (7 and 8) for wear or damage and replace as necessary.

INSTALL

- 1. Clean all parts, excluding shoe and lining assemblies (2), not being replaced in clean denatured alcohol. Lube wear bracket (14) and wear shims (15) with a thin coating of 5450032 or equivalent.
- 2. Fit shoe and linings (2) to mounting plate (1). Primary and secondary shoe and assemblies are identical. **NOTE:** Make sure operating lever and strut assembly (6) is positioned on the wear shims (15), not down in the hole.
- 3. Install shoe return spring (7) with suitable pliers.

- 4. Install pins (4) and hold down springs (3) by fitting to shoe and then depressing the spring to extend the pin head through the hole in the backing plate and then down into the slot.
- 5. Install the adjuster return spring (8).
- 6. Install the adjuster assembly (13), making sure the star wheel is positioned properly, star wheel toward front.
- 7. Adjust shoe and lining assemblies and cable after installing rotor and caliper per parking brake adjuster procedure.

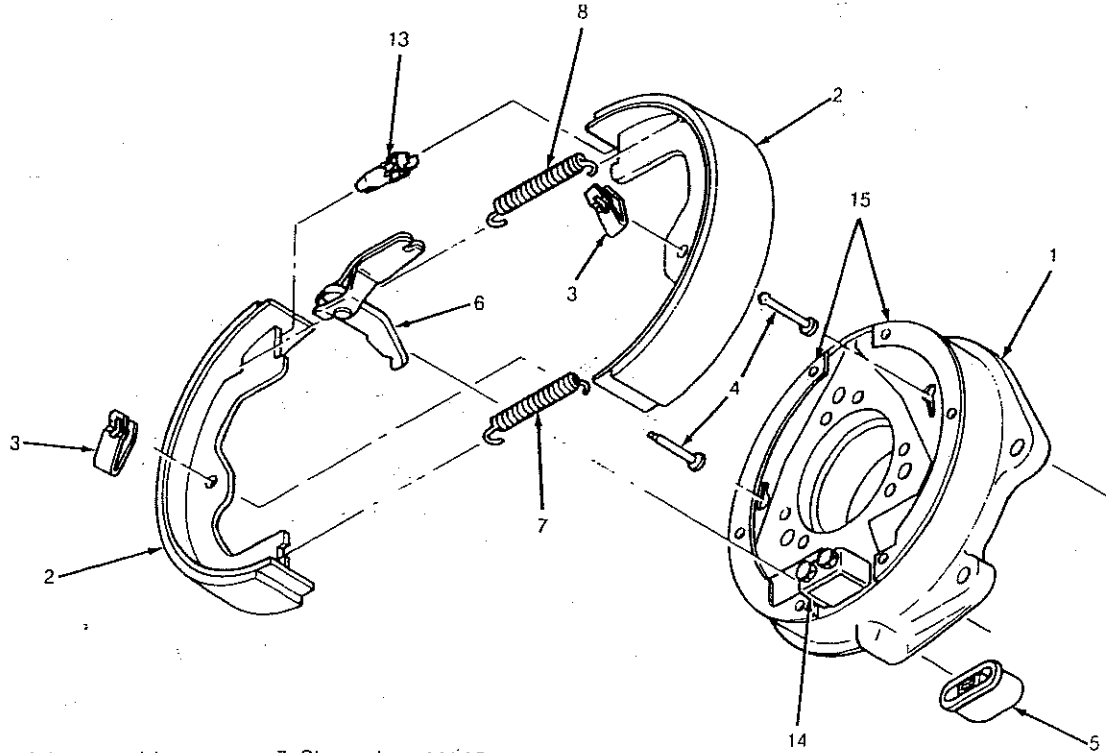

- 1. Mounting plate assembly
- 2. Shoe and lining
- 3. Hold-down spring
- 4. Hold-down pin
- 5. Boot
- 6. Lever and strut assembly
- 7. Shoe return spring
- 8. Adjuster return spring
- 13. Adjuster assembly
- 14. Wear bracket
- 15. Wear shim

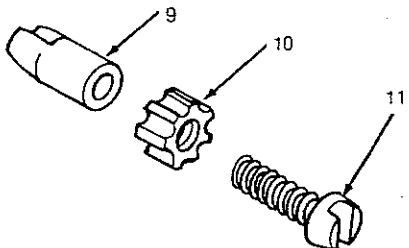

- 9. Adjuster socket
- 10. Adjuster nut
- 11. Adjuster screw