



1-800-327-4868

Seal Kit Part # 39162

Z39162-2

Suggested Instructions for installing Power Steering

replace Power Cylinder Assembly

For Service other than Shaft Seal Replacement,

1. Disconnect the two hydraulic lines from the Power Cylinder and mark their location for reinstallation as they are interchangeable and easily reversed during re-assembly.
2. Remove the Cotter Pin, nut, and attaching parts from rod end of Cylinder from Frame Bracket.
3. Remove Cotter pin, nut, and Ball Stud at Steering Relay Rod and remove Power Cylinder from Vehicle.
4. Remove Snap ring from Shaft making sure you do not damage the Shaft.
5. Slowly move the Shaft in and out slowly to remove the oil inside the housing through the fitting holes.
6. Remove the Piston Rod Scraper, Scraper Element, Back Up Washer, And Piston Rod Seal from the housing.
7. Air Pressure can be applied to the line fitting holes to assist in removing the Seals or a suitable Pick tool can be used. **DO NOT SCRATCH THE SHAFT!!!**
8. Clean all Surfaces and Lubricate Seal Parts with Lubriplate or Vaseline prior to installation.
9. Install the Shaft Seal first with the Spring Side installed toward the Cylinder.
10. Install the Silver Back up Washer.
11. Install the Leather Scraper Element with the Rough Side toward the Cylinder.
12. Install the Brass Colored Rod Scraper Washer with the raised side to the outside or Shaft End.
13. Install the Snap Ring.
14. Install the Black Conical Ball Stud Seal on the Ball Stud.
15. Install the Shaft Bracket Bushings and Spacer Dowel and Reinstall Power Cylinder into Vehicle.
16. Reconnect Hoses into proper fitting holes and add correct amount of Fluid.
17. Start Vehicle and check operation and check for leaks. It will take several minutes for the system to purge itself of air, and a grinding noise may occur during this period.
18. Check fluid level after operation.

1. Snap Ring
2. End Plug & Lube Fitting
3. "O" Ring
4. Spring
5. Spring Seat
6. Ball Stud
7. Ball Seat
8. Ball Stud Seal
9. Piston Body
10. Piston Rod Seal
11. Backup Washer
12. Scraper Element
13. Piston Rod Scraper
14. Snap Ring
15. Piston Rod

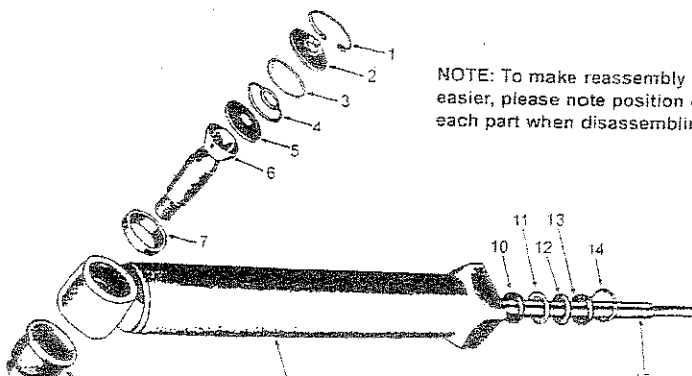

NOTE: To make reassembly easier, please note position of each part when disassembling.